



W  
WHITES

Flat 11 Old School House, 161 Fisherton Street, Salisbury, Wiltshire, SP2 7RP

£950 PCM

## About The Property

A modern and well appointed second floor one bedroom apartment within a converted former Victorian Edwardian building. Accommodation comprises gated main entrance, path to communal entrance hall with entry phone system, open plan living area with fully equipped kitchen incorporating integral f/f, w/m, electric oven and gas hob. Bathroom features travertine stone, mains operated sanitary ware and an electric shower over the bath. Spacious double bedroom with large built-in hanging cupboard. Large storage closet in sitting room. Gas central heating. Superbly located for Salisbury train station and within easy walking into city centre. Suit professional person. Street permit parking. UNFURNISHED.

- One bedroom apartment
- Second floor
- Converted former Victorian Edwardian Building
- City Centre nearby
- Close to Salisbury train station
- Gas central heating
- Integral appliances
- Communal courtyard garden



527.00 sq ft

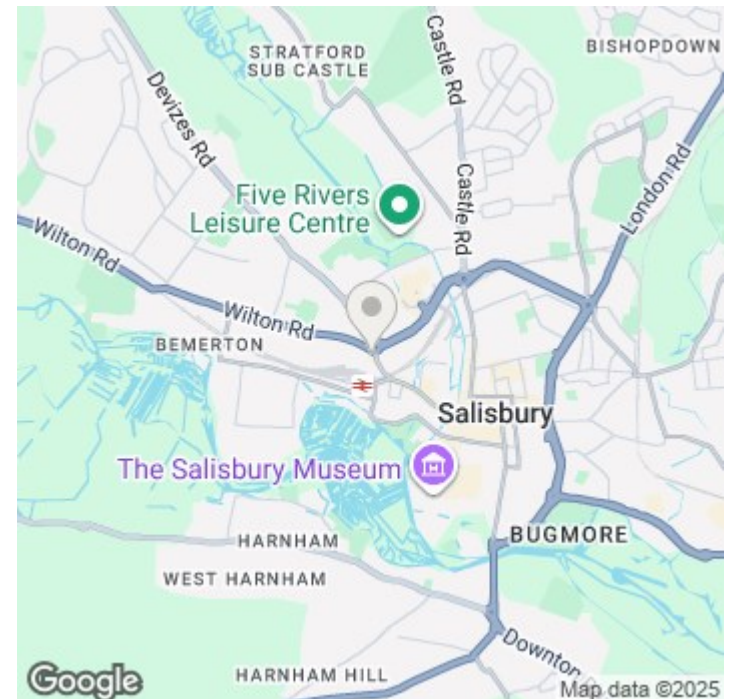





## Third Floor

Approx. 49.0 sq. metres (527.4 sq. feet)

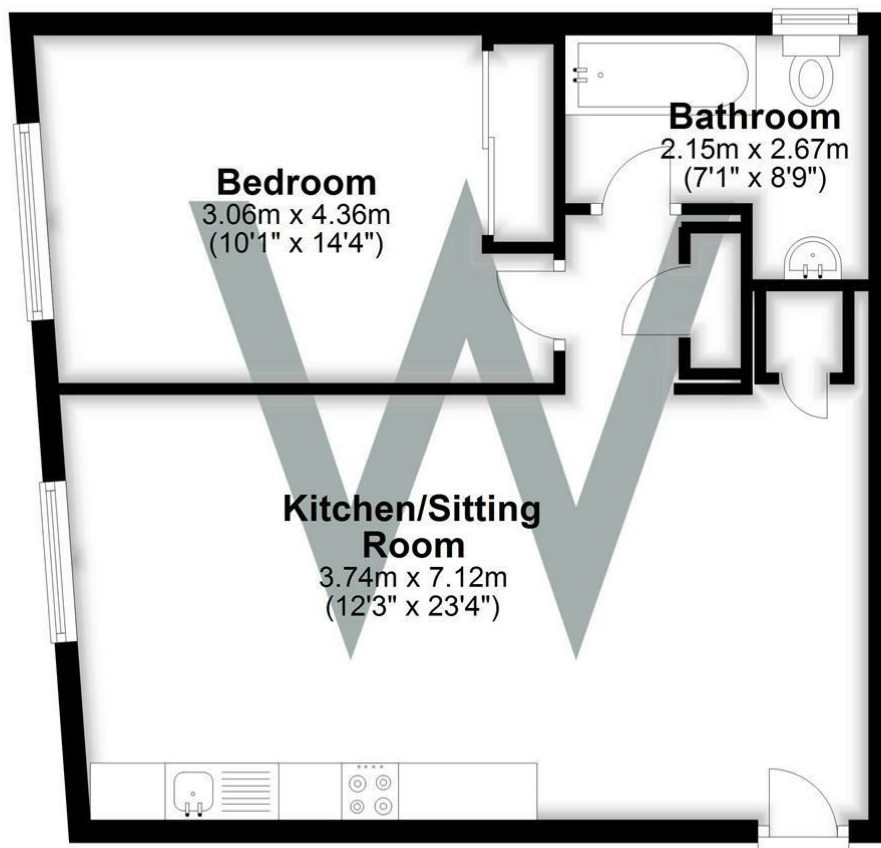

Total area: approx. 49.0 sq. metres (527.4 sq. feet)

## Further Information

Let available date: 1st December 2025 NB: This date is provisional and will only be confirmed once referencing has been successfully completed.

Property type: Apartment

Furnish type: Unfurnished

Deposit: £1,095

Local authority: Wiltshire Council

Council Tax: Band B

EPC: C(79)

### Energy Efficiency Rating

	Current	Potential
Very energy efficient - lower running costs		
(92 plus) <b>A</b>		
(81-91) <b>B</b>		
(69-80) <b>C</b>	79	79
(55-68) <b>D</b>		
(39-54) <b>E</b>		
(21-38) <b>F</b>		
(1-20) <b>G</b>		
Not energy efficient - higher running costs		
<b>England &amp; Wales</b>	EU Directive 2002/91/EC 